



## Joan B. Kroc Institute for Peace and Justice Venue

University of San Diego  
Joan B. Kroc School  
of Peace Studies  
5998 Alcalá Park  
San Diego, CA 92110  
(619) 260-7808  
Krocvenue@sandiego.edu  
sandiego.edu/kroc-venue



## Beautiful. Unique. Inspirational.

The University of San Diego's Joan B. Kroc Institute for Peace and Justice venue, home of the Kroc School of Peace Studies, features 15,000 square feet of versatile meeting and event space designed to stimulate discussion, collaboration and learning. Our campus is centrally located just minutes from the San Diego International Airport and downtown.

### GARDEN OF THE SKY

Plaza with views of USD's campus welcomes your guests to event registration, vendors, casual lunches and receptions for 50-500.

### PEACE AND JUSTICE THEATRE

This unique and surprisingly intimate auditorium is suitable for plenary sessions, keynote speakers, trainings, panel discussions, films, performances and distinctive ceremonies.

- » 288 fixed seats
- » Dual, rear-screen high-definition LCD projection
- » Audio/video conferencing and recording
- » Private green rooms for presenters and conference staff
- » Experienced audio-visual team

### CONFERENCE AND MEETING SPACE

Nine versatile meeting rooms for hosting an all-day directors' meeting for 10, multiple breakout sessions and catered meals for up to 300.

### BOARDROOM

The executive boardroom seats up to 35 in luxurious, Italian leather upholstered chairs.

- » Horseshoe-shape table with built-in microphones
- » Presentation control desk
- » Rear-screen LCD projection with confidence monitor
- » Audio conferencing and recording

### GARDEN OF THE SEA

Lush gardens, a reflecting pool and spectacular views from San Diego's Mission Bay to the Pacific Ocean make this an exceptional location for hosting special events, receptions, luncheons and dinners for 50-700.

### HOSPITALITY SERVICES

USD Catering is a nationally recognized, award-winning caterer that delivers excellence and quality at affordable prices.



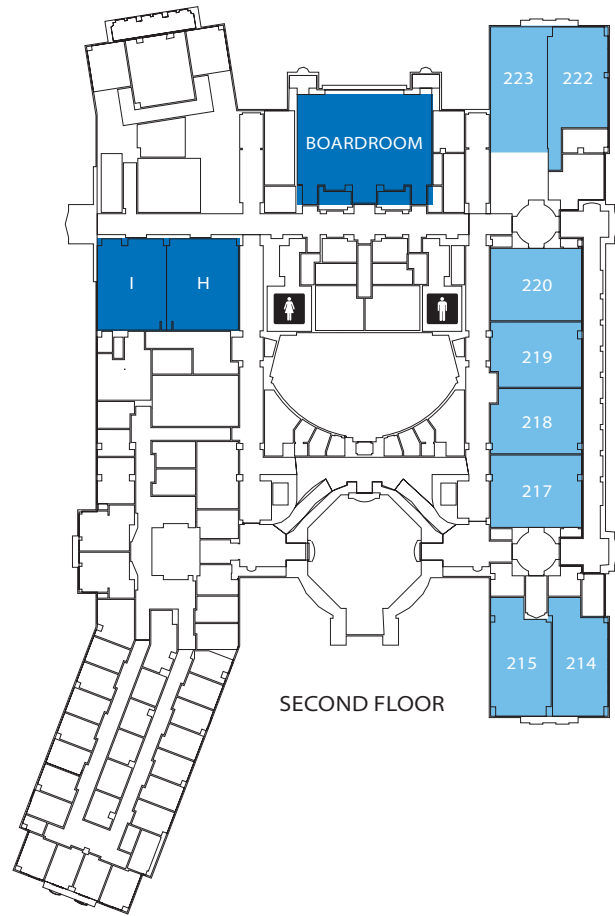
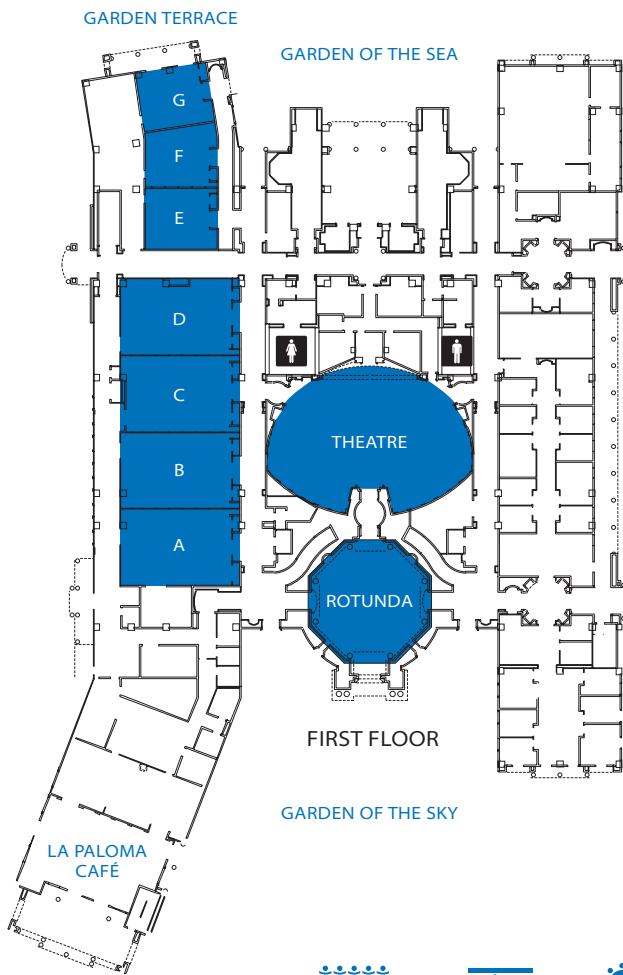

### Space and Capacity



FIRST FLOOR INTERIOR*	AUDITORIUM	CLASSROOM 2 PER/3 PER	ROUNDS SERVED/BUFFET	CONFERENCE TABLE	U-SHAPE	RECEPTION	APPROX SQ. FT.	BUILT-IN AV
Rotunda	n/a	n/a	n/a	n/a	n/a	150	1850	
Peace and Justice Theatre	288	n/a	n/a	n/a	n/a	n/a	3300	•
Room A, B, C or D	75	30/45	64/56	30	24	50	1150	•
Room AB or BC or CD	158	68/102	136/120	50	36	150	2300	•
Room ABC or BCD	234	106/159	224/192	n/a	n/a	200	3500	•
Room ABCD	320	132/198	288/224	n/a	n/a	300	4660	•
Room E or F	40	16/24	32	24	18	30	560	
Room EF	84	28/42	56	40	27	60	1130	
Room G	38	12/18	32	24	18	30	530	
<b>SECOND FLOOR INTERIOR*</b>								
Room H or I	60	24/36	48/40	30	24	50	950	
Room HI	120	60/90	88/72	50	39	150	1860	
Boardroom	n/a	n/a	n/a	35	n/a	n/a	2000	•
Classrooms	45	n/a	n/a	n/a	n/a	n/a	950	•
<b>OUTDOOR VENUES*</b>								
Garden of the Sky	300	n/a	200	n/a	n/a	500		
Garden Terrace	100	n/a	80	n/a	n/a	125		
Garden of the Sea	n/a	n/a	300	n/a	n/a	700		

\*ADA compliant and wireless internet

For more information or reservations, visit [sandiego.edu/kroc-venue](http://sandiego.edu/kroc-venue), call (619) 260-7808 or email [krocvenue@sandiego.edu](mailto:krocvenue@sandiego.edu).